

# SecurTransLock



**SAIMA**  
*The art of security*

## HIGHLIGHT

The SecurTransLock is a dual corridor security portal designed to ensure unicity of passage while maintaining optimal throughput.

With the anti-tailgating and anti-piggybacking function, the SecurTransLock guarantees the entry of one person at a time. With the SecurTransLock system installed, security personnel can be reduced or eliminated completely saving tens to hundreds of thousands of dollars per year.

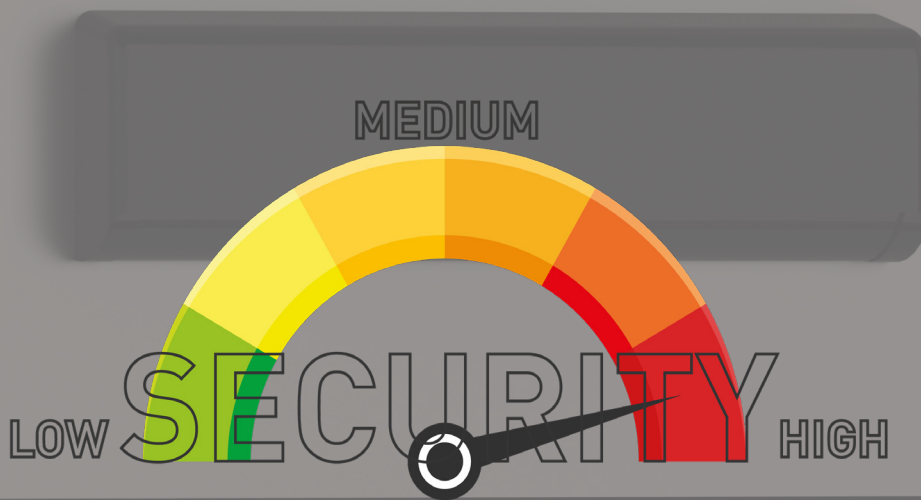

## OVERVIEW

The user's validation at the entrance is typically via card or biometric. Upon ACS clearance with valid entry authorization, the door opens and the user enters the section. Upon entry path the anti piggybacking and anti tailgating system is working. If the user is a single person, they will be granted entry. If an unauthorized user is detected, the door locks.

The robust door structure is made of welded steel and sheet metal finish. Higher security versions of the SecurTransLock can also be equipped with bullet resistant glass.



ANTI PIGGYBACKING  
SYSTEM



ANTI TAILGATING SYSTEM



INTEGRATION WITH  
ACCESS CONTROL  
SYSTEMS



FINISHED BASE



BULLET RESISTANCE



VANDAL RESISTANCE

## OPTIONAL



METAL DETECTOR

## SECURITY FEATURES

The SecurTransLock is equipped with a stereo-camera system that grants the entrance of only one person at a time. This system creates a 3D image of objects passing through the door.



By evaluating the size and positioning of objects, Saima proprietary algorithms system can prevent even the most elaborate attempts to gain entry via piggybacking. Using field of vision of the images acquired from several points of view, moving objects can be effectively recognized. This lets the system distinguish between tall or larger people and people with bags or packs for example.

## PRODUCT LAYOUT



STANDARD VERSION

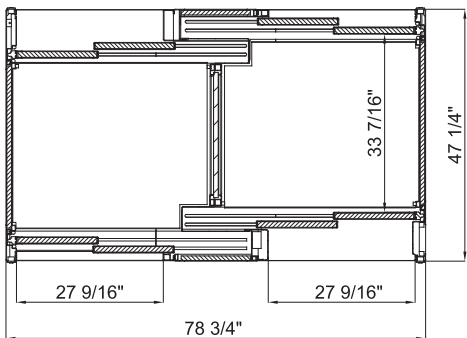
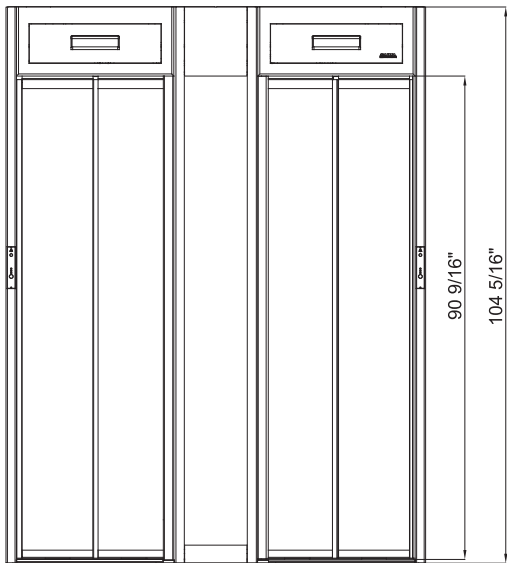

## WITH METAL DETECTOR



The metal detection columns accurately detect metallic objects like handguns. The SecurTransLock structure is conceived to accommodate the tubular add-ons on each side of the portal entrance(s).

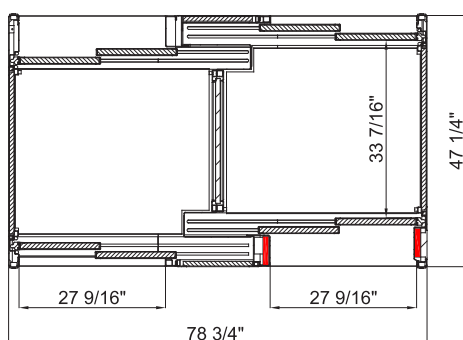
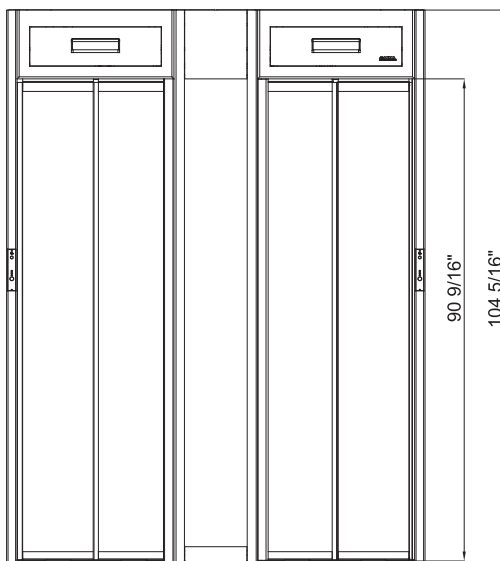

## ENTRY / EXIT WORKING FLOW

Entry of two persons one authorized and the other unauthorized

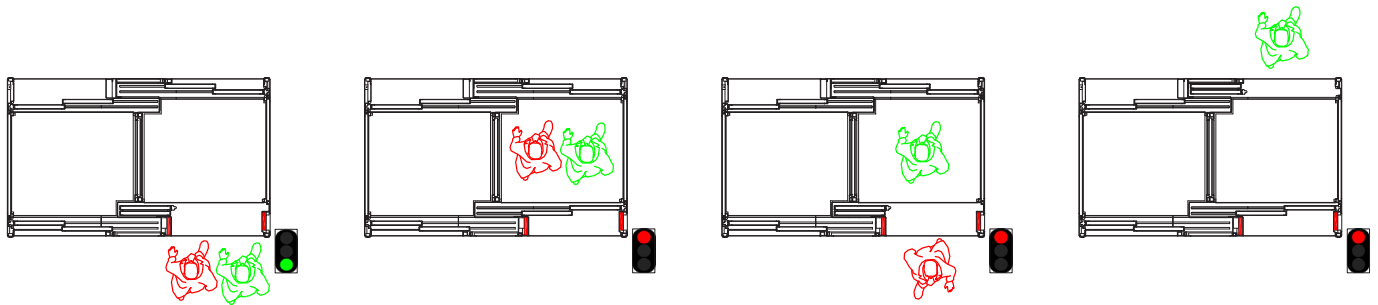

Unauthorized gun entry

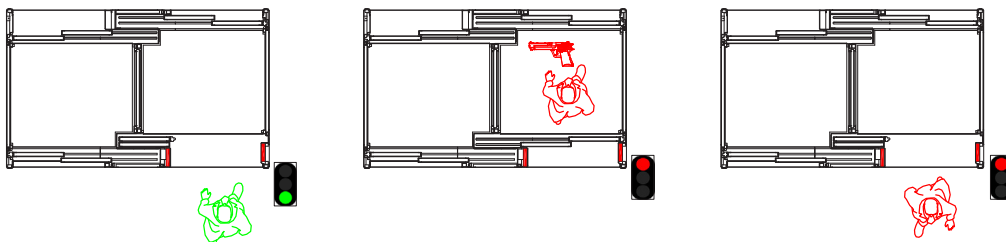

Authorized entry access

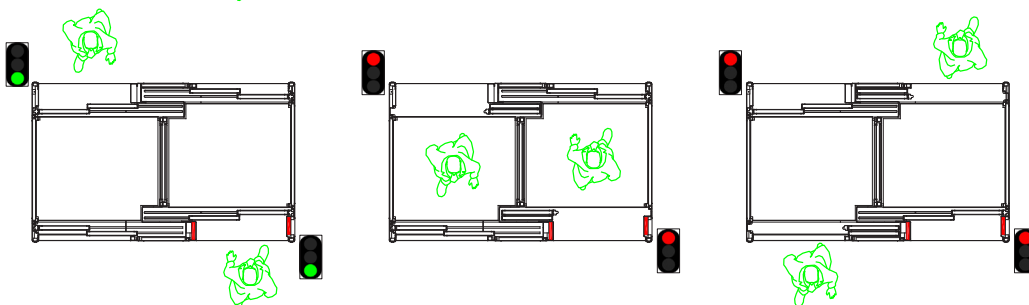



## STANDARD EQUIPMENT

1. Doors glasses BR3S, P6B and lateral glasses BR2S, P6B.
2. Lighting by means LED spots placed on the internal space.
3. Modular assembly.
4. Metal canopy cover. Optional sealed canopy. (provided by 3rd party)
5. Internal canopy opening for maintenance.
6. Voice module for unauthorized users.
7. Security block in closer with mechanical locking mechanism.
8. First in last out key.
9. Infrared safety sensors and motor torque electronic control.
10. Serial ports for external interfacing (RS 232 RS 485).
11. Programmable control panel with intercom system.
12. Authorized/unauthorized users LED lighting system and push button used to open the doors.
13. In case of power breakdown the doors can be opened manually.
14. Internal emergency button.

## OPTIONAL EQUIPMENT

- Thermal scanner.
- Height extensions.
- Metal detector with automatic reset after each alarm, and sensor inside to detect the presence of metal object left inside.
- 18 Ah built-in battery backup.
- Internal /External support either for card or proximity reader.
- Internal microcamera.
- Doors opening radar.
- Additional console.
- Additional input/output card (I/O)
- (Canopy) heating system.
- Sanification unit.

## TECHNICAL DATA

Power Supply	220Vac (+/- 10%) 50Hz or 110Vac (+/- 10%) 60Hz
Maximum power	400W
Operational conditions	14 °F / 131° F IP 33
Backup Battery	4 x 7Ah sealed lead-acid batteries.
Motors	4 x 24VDC for reversable movement of the shutters, with secutiry block for closure.
Operating logic	Programmable with microprocessor and connectivity.
Safety	Photocell on vertical rod of the doors both of entrance and exit and control system period.
Throughput	- 6 authorized users per minute 1 direction mode - 12 authorized users per minut 2 direction mode
STANDARDS	UL rated components (allowing on-site certification)

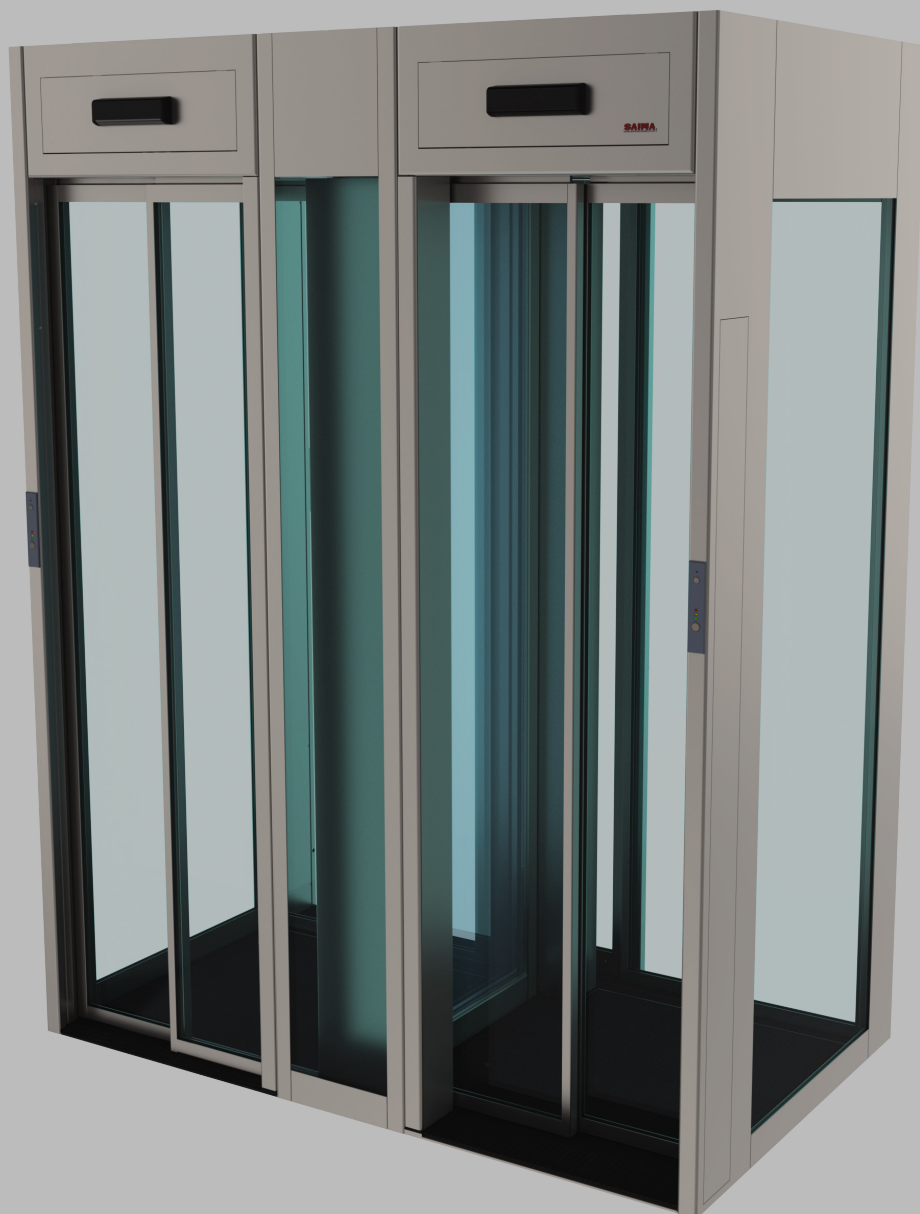





**SAIMA**

[www.saimaamerica.com](http://www.saimaamerica.com)

961 Route 10 East Suite 2K  
Randolph, NJ 07869

1-973-970-9703



MADE IN ITALY